

# Mardome

## Kerb & Fixing Options



Daylight Systems



**mardome**trade  
Dome Rooflights

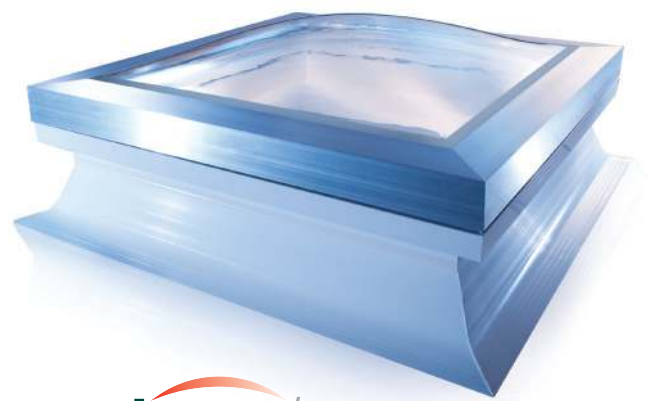

**mardome**ultra  
Dome Rooflights



Providing superior installation solutions for Mardome Trade and Ultra rooflights, Brett Martin Daylight Systems offer a range of technically advanced kerb and fixing options for flat, low pitched or curved roof structures where the roof pitch does not exceed 15°. Designed and developed in the UK by Brett Martin's own in-house product development team, contractors, specifiers and clients have the assurance that the Mardome kerb and fixing options have been developed holistically with full consideration to the overall aesthetics and performance of Mardome Trade and Ultra dome rooflights. With options for new build and refurbishment projects, with or without a builders upstand and fully compatible with a range of roofing systems including single ply, bituminous, metal, liquid applied and asphalt, Brett Martin continue to offer competitively priced market leading daylight solutions.

## Mardome Trade and Ultra Kerb and Fixing Options

### Factory Assembled Mardome Kerbs

- Standard Kerb - new build projects without an upstand
- Tall Kerb - refurbishment projects where there is an upgrade of insulation

### Alternative Fixing Options

- Direct Fix Kerb - fitting to standard sized builders up stand
- Kerb Adapter - fitting to non-standard sized builders upstand
- Soaker - fitting to profiled metal roofs



## Section 1

### Factory Assembled Mardome Kerbs

Factory assembled Mardome kerbs in two height options, 216mm and 365mm, are available for projects with no existing upstand and in a range of sizes to match standard dome sizes. Made from white multiwall PVC, the kerb is extremely robust and has been designed to provide maximum insulation, whilst its steep sloped walls allow for a significantly larger glazing unit on top providing more daylight into the area beneath. All actuators on powered units are concealed within the kerb's walls giving a sleek and stylish internal look. The specially designed radiused base allows roof coverings to be applied to the kerb without the need for timber fillets, whilst an integral clamp holds roof coverings in place for complete weather tightness and a neat and tidy finish.

### Features

- Designed for use with Mardome Trade and Mardome Ultra dome rooflights
- Approved for use with all major flat roofing manufacturers systems
- Two height options: Standard (216mm) and Tall (365mm)
- Increased insulation provided by the thermally efficient multiwall kerb
- Manufactured from PVC which is light in weight yet robust and resilient to damage
- Actuators and powered opening components completely concealed within the kerb
- Almost vertical kerb walls allow a larger glazing area for more natural daylight
- The kerb is supplied prefinished internally in white PVC

### Option 1A - Mardome Standard Kerb

Roof covering terminates 150mm above roof level

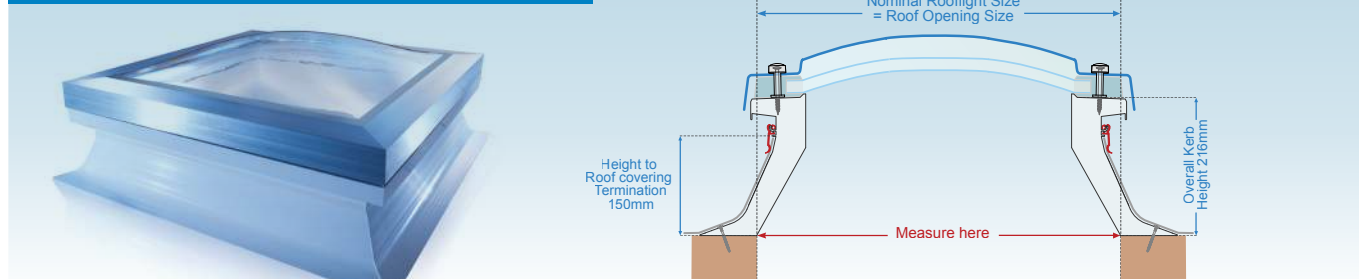

### Option 1B - Mardome Tall Kerb

Roof covering terminates 300mm above roof level

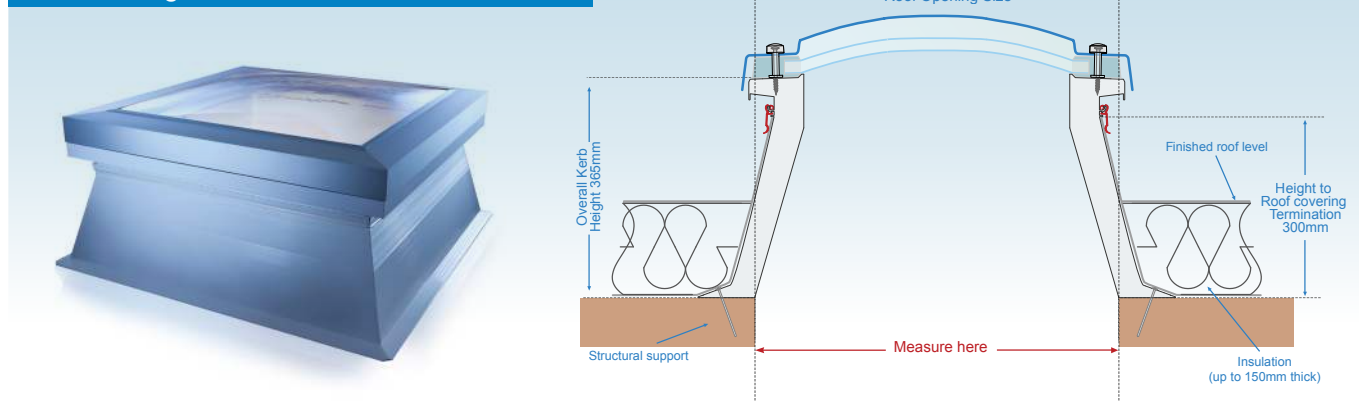

- Designed for use where the base of the kerb will be mounted below finished roof level
- Ideal for refurbishment projects where insulation is being added on top of the existing roof and for tapered insulation projects.

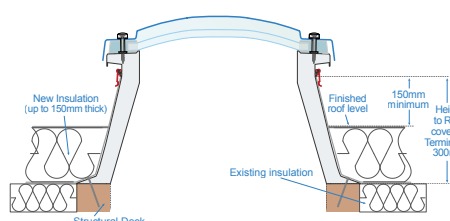

Refurbishment - When insulation  
thickness is increased

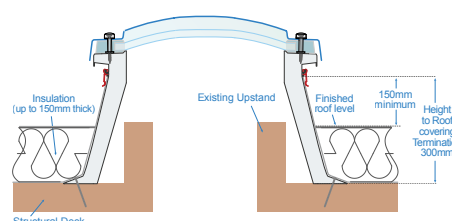

Refurbishment - Oversailing existing  
rooflight upstand

## Section 2

### Alternative Fixing Options

#### Option 2A - Mardome Direct Fix Kerb

##### Fitting to standard sized builders up stand

Unvented Mardome Trade on builders upstand

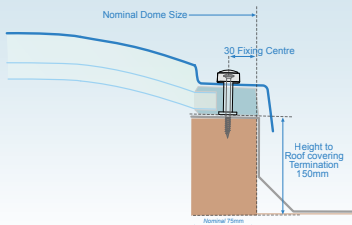

Vented Mardome Trade on builders upstand

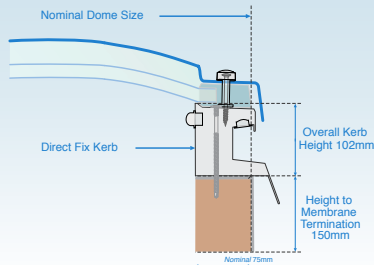

Fixed Mardome Ultra on builders upstand

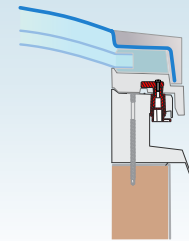

Opening Mardome Trade on builders upstand

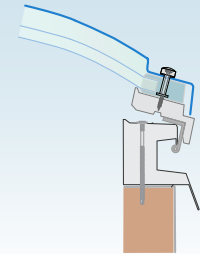

An unvented Mardome Trade can be fitted directly to a builder's upstand. For vented or opening Mardome Trades and all Mardome Ultras, a direct fix kerb is supplied as standard to facilitate fixing to the builders upstand.

#### Option 2B - Mardome Kerb Adapter

##### Fitting to non-standard sized builder's upstand

Unvented Mardome Trade on kerb adapter

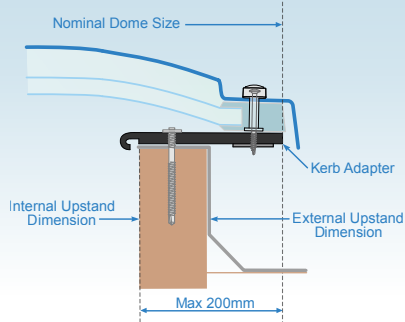

Vented Mardome Trade on kerb adapter

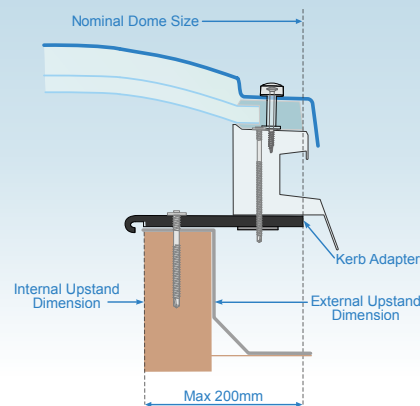

Opening Mardome Trade on kerb adapter

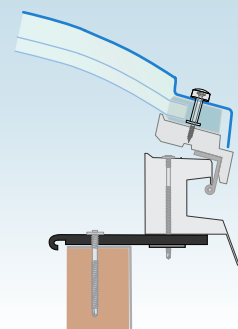

If nominal rooflight size (roof opening + builders upstand width) is a non-standard dome size then a Mardome Kerb Adapter can be supplied to allow standard sized domes to be fitted. The kerb adapter extends up to 200mm from the internal upstand dimension to accommodate a larger dome size. An unvented Mardome Trade can be fitted directly to the kerb adapter. For vented Mardome Trades and all Mardome Ultras, the direct fix kerb, supplied as standard, fits directly on to the kerb adapter.

#### Option 2C - Mardome Soaker

##### Fitting to profiled metal roofs

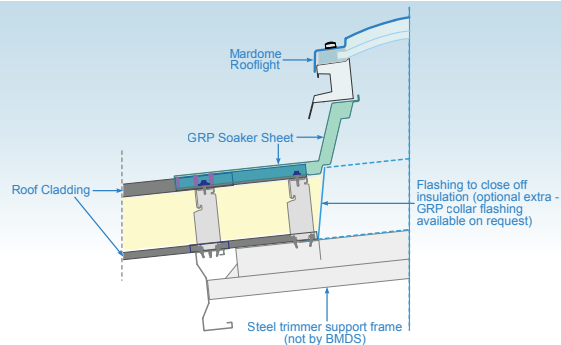
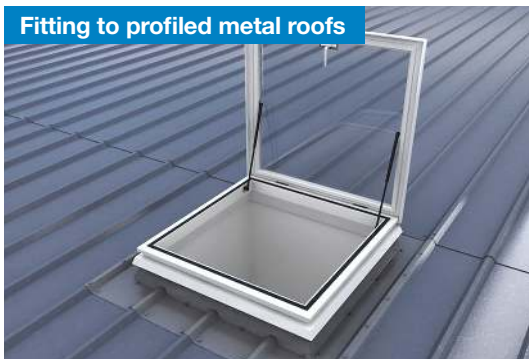

Mardome Trade and Mardome Ultra rooflights can be fitted to profiled metal roofs using a Mardome Soaker.

- Corrugated GRP unit with an insulated upstand for fixing to most metal roofing profiles.
- Non-vented and non-opening domes fixed directly to soaker.
- All vented and opening domes supplied with lower frame and fixed directly to soaker.



## Daylight Systems

UK and Ireland Sales Enquiries

Brett Martin Daylight Systems Ltd,  
Sandford Close,  
Aldermans Green Industrial Estate,  
Coventry, West Midlands CV2 2QU  
Tel: +44 (0) 24 7660 2022  
Fax: +44 (0) 24 7660 2745  
Email: [daylight@brettmartin.com](mailto:daylight@brettmartin.com)

For the latest information  
visit the company's website:  
[www.brettmartin.com](http://www.brettmartin.com)

DOWNLOAD  
OUR FREE APP



All reasonable care has been taken in the compilation of the information contained within this literature. All recommendations on the use of our products are made without guarantee as conditions of use are beyond the control of Brett Martin. It is the customer's responsibility to ensure that the product is fit for its intended purpose and that the actual conditions of use are suitable. Brett Martin pursues a policy of continuous product development and reserves the right to amend specifications without prior notice.